

inserts:		page
CK	3 poles + ⊕	36
CK	4 poles + ⊕	36
CKS	3 poles + ⊕	37
CKS	4 poles + ⊕	37
CD	7 poles + ⊕	39
CD	8 poles	40
CQ	5 poles + ⊕	63
CQ	12 poles + ⊕	62

overall dimensions:
21 x 21 mm

bulkhead housings



angled bulkhead housings



description	part No.	part No. (entry - Pg 11)	part No. (entry - M 20)
with lever ¹⁾	CK 03 I (white)		
with lever ¹⁾	CK 03 IN (black)		
without cable gland outlet, with lever ¹⁾		CK 03 IA (white)	
without cable gland outlet, with lever ¹⁾		CK 03 IAN (black)	
with threaded entry and lever ¹⁾		CK 03 IAPS (white)	MK IAP20 (white)
with threaded entry and lever ¹⁾		CK 03 IAPNS (black)	MK IAPN20 (black)
seal and screw kit for IP66/IP67 ²⁾ for CK, CQ 05, CKS inserts	CKR 65	CKR 65	
seal and screw kit for IP66/IP67 ²⁾ for CD 07/08 inserts	CKR 65 D	CKR 65 D	

panel cut-out for enclosures, in mm

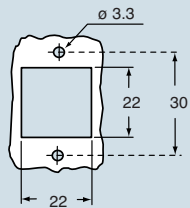

- enclosures with IP44 degree of protection, obtained by the elimination of the flexible washer normal supplied with the insert
- To achieve the IP66/IP67 protection rating, a kit is available which includes a seal to be fitted under the insert fastening screw supplied with the kit (see example illustrated), instead of the screw with spring washer supplied with the insert

Note:
The CQ 12 inserts are already fitted with seal and screw, allowing IP66/IP67 protection rating to be achieved.

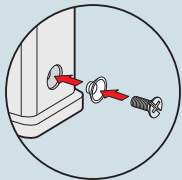

CRUS® Type 12
Type 4/4X only
with CKR 65 (D)

dimensions shown are not binding
and may be changed without notice

dimensions in mm

CK I(N)

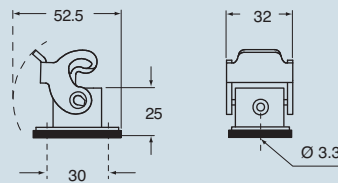

dimensions in mm

CK IA(N)

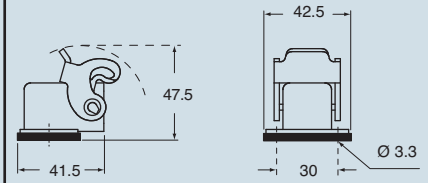

CK IAP(N)S and MK IAP(N)

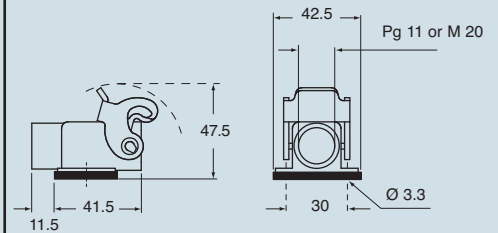

size 21.21